

Cornaway 210 Sliding Door System

FOR DOORS SLIDING FROM THE OPENING TO SIDE WALL OR WALLS

APPLICATION

Top hung angle sliding doors for residential garages and light industrial use etc.

RANGE

Maximum weight per door leaf 36kg (80lb)
 Maximum door height 2.4m (8ft)
 Maximum opening width Unlimited
 Maximum door leaf width 1m (3ft 3ins)
 Up to 5 leaves may be hinged together.
 Consider door area in exposed positions.

DOOR CONSTRUCTION

Door thickness 38 to 44mm. All door leaves equal width. If swing leaves hinged to sliding doors reduce door widths to 700mm. If depth of return wall exceeds radius of curve by 75mm or more, a swing leaf is not essential.

FIXING

Side fixing standard. It is essential that top tracks and floor channels are plumb. Notch top corners of doors where shown, to clear stop at head. Hangers and guides have vertical adjustments.

HANGERS

All steel, ball bearing, lubricated for life. Pressed steel backflaps, 2-217 End pattern. 2-221 Centre pattern.

TRACK

2-16 (1.6mm) Galvanised steel to BS EN 10142. Lengths 1.8m to 6.0m. Curves radius 600mm.

TRACK BRACKETS

Steel. See drawing and full range page 3.

INTERMEDIATE HINGES

95-500 Pressed steel backflaps.

DOOR GUIDES

Pressed steel backflaps, brass roller. 44-317 End pattern. 44-321 Centre pattern.

FLOOR CHANNEL

44-1 Galvanised steel, lugs available for concrete with connecting shoes for joints. Lengths 1.8m to 4.0m. Curves radius 600mm.

DOOR STOPS

97-711 Steel with rubber buffers, fixed mid-height of doors.

FURNITURE

Full range of door furniture available.

FINISHES

Top track galvanised, brackets and backflaps zinc plated.

EXAMPLE

Quantities for a door opening 2.4m wide x 2.1 m high. 250mm return. Weight of each leaf 30kg. Four leaves sliding one way.

A TYPICAL BILL OF QUANTITIES

ITEM				
A	2-16	Track 1 x 1.8m 1 x 2.1m	3.9	LIN.M
B	2-16-600	Track curve 600mm Rad.	1	NO.
C	2-100	Bracket, open, side wall	8	NO.
D	2-051	Closed end pieces (pair)	1	NO.
E	2-002	Lock joint plates	2	NO.
F		Bolts for brackets (by others)	8	NO.
G	2-217	End hanger	1	NO.
H	2-221	Centre hanger	3	NO.
J	95-500	Backflap hinge	3	NO.
K	44-317	End guide	1	NO.
L	44-321	Centre guide	3	NO.
M	44-1	Channel 1 x 2.1m 1 x 2.4m	4.5	LIN.M
N	44-1-600	Channel curve 600mm Rad	1	NO.
O	44-011	Connecting shoes	2	NO.
P	44-010	Channel lugs (pack)	3	NO.
Q	95-570	Guide roller bolt	1	NO.
R	95-605	Bow handle	2	NO.
S	95-619	Flush handle	1	NO.
T	97-711	Door stop	1	NO.
U	95-644	Cylinder latch	1	NO.

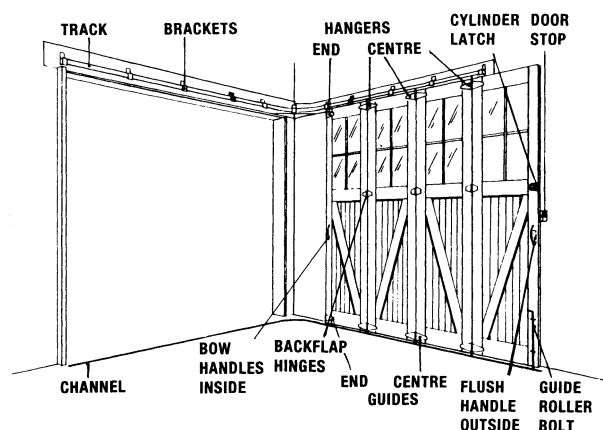

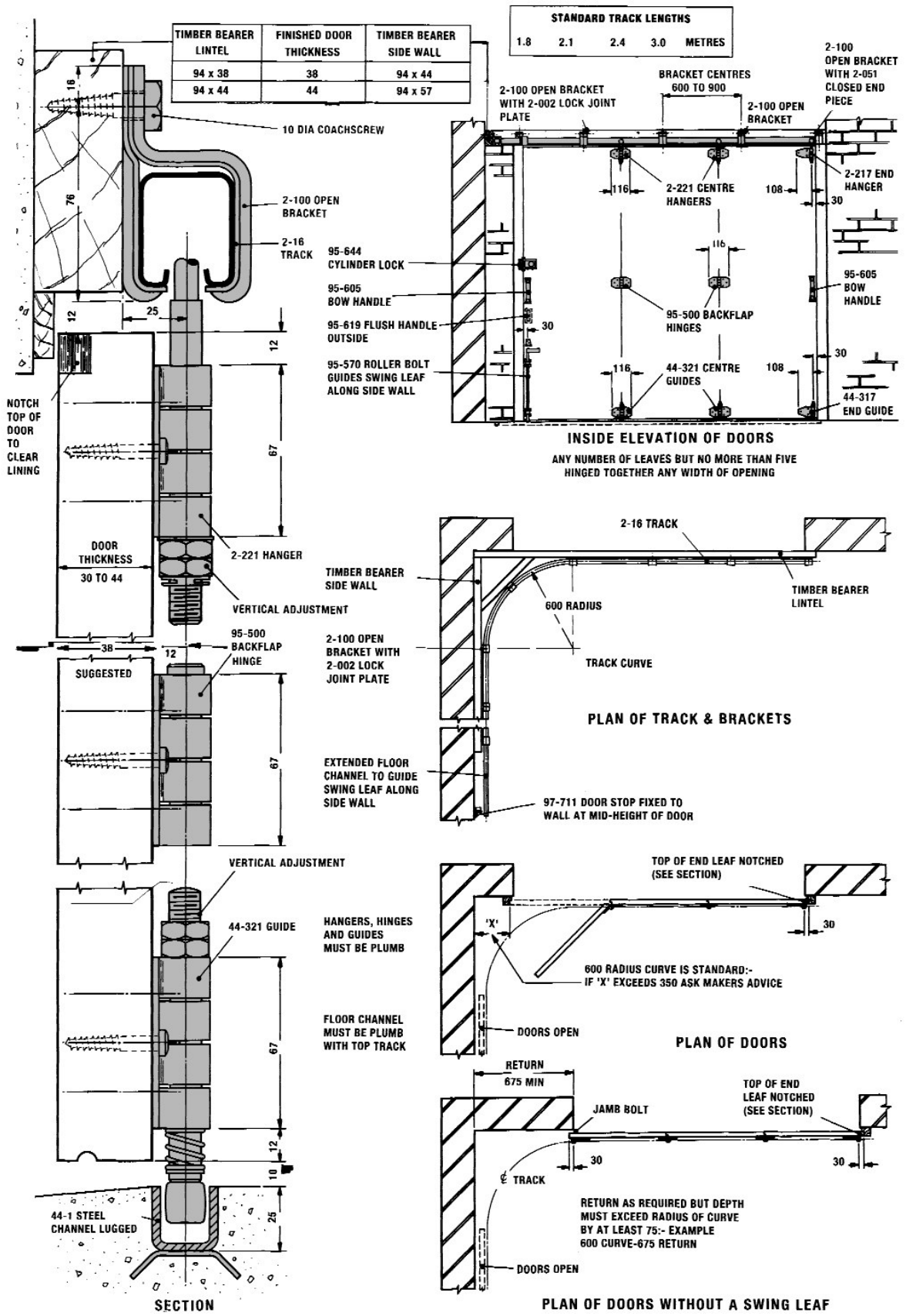

INSIDE ELEVATION OF DOORS

ANY NUMBER OF LEAVES BUT NO MORE THAN FIVE HINGED TOGETHER ANY WIDTH OF OPENING

PLAN OF TRACK & BRACKETS

PLAN OF DOORS

PLAN OF DOORS WITHOUT A SWING LEAF

Cornaway 310 Sliding Door System

FOR DOORS SLIDING FROM THE OPENING TO THE SIDE WALL OR WALLS

APPLICATION

Top hung angle sliding doors for domestic and industrial use. For garages, factories, etc.

RANGE

Track size	3-20	3-25
Maximum weight per door leaf	50kg (110lb)	60kg (130lb)
Maximum door height	3.3m (11ft)	3.6m (12ft)
Maximum opening width	Unlimited	Unlimited
Maximum door leaf width	1m (3ft 3ins)	1m (3ft 3ins)

Up to 5 leaves may be hinged together. Consider door area in exposed positions.

DOOR CONSTRUCTION

Door thickness 44 to 57mm. All door leaves equal width. If swing leaves hinged to sliding doors reduced door widths by 100mm, height by 300mm and weight by 10kg. If depth of return wall exceeds radius of curve by 75mm or more, a swing leaf is not essential.

FIXING

Side fixing standard. It is essential that top tracks and floor channels are plumb. Notch top corners of door where shown to clear stop at head. Hangers and guides have vertical adjustment.

HANGERS

All steel ball bearing, lubricated for life, malleable backflaps. 3-218 End pattern. 3-222 Centre pattern.

TRACK

3-20 (2.0mm) 3-25 (2.5mm) Galvanised steel to BS EN 10142. Lengths 1.8m to 6.0m. Curves radius 600mm.

TRACK BRACKETS

Steel. See drawing and full range page 3.

INTERMEDIATE HINGES

95-501 Pressed steel plated backflaps.

DOOR GUIDES

Malleable backflaps, brass roller. 45-318 End pattern. 45-322 Centre pattern

FLOOR CHANNEL

45-1 Galvanised Steel, continuously lugged for concrete. Lengths 1.8m to 3.0m. Curves radius 600mm.

DOOR STOPS

97-711 Steel, fixed mid-height of doors.

FURNITURE

Full range of door furniture available.

FINISHES

Top track galvanised, brackets and backflaps zinc plated.

EXAMPLE

Quantities for a door opening 3.4m wide x 2.7 high. 225mm return. Weight of each leaf 45kg. Four leaves sliding one way.

A TYPICAL BILL OF QUANTITIES

ITEM				
A	3-20	Track 2 x 3.0m	6.0	LIN.M
B	3-20-600	Track curve 600mm Rad.	1	NO.
C	3-100	Bracket, open, side wall	11	NO.
D	3-051	Closed end pieces	2	NO.
E	3-002	Lock joint plates	2	NO.
F		Bolts for brackets (by others)	11	NO.
G	3-218	End hanger	1	NO.
H	3-222	Centre hanger	3	NO.
J	95-501	Backflap Hinge	3	NO.
K	45-318	End guide	1	NO.
L	45-322	Centre guide	3	NO.
M	45-1	Channel 1 x 3.0m 2 x 1.8m	6.6	LIN.M
N	45-1-600	Channel curve 600mm Rad	1	NO.
O	45-011	Connecting shoes	3	NO.
P	95-571	Guide roller bolt	1	NO.
Q	95-605	Bow handle	2	NO.
R	95-619	Flush handle	1	NO.
S	97-711	Door stop	1	NO.
T	95-644	Cylinder latch	1	NO.

